

LSL-1 SERVICE INSTRUCTIONS

PRODUCT DESCRIPTION

THE LSL-1A INJECTOR IS DESIGNED FOR STANDARD OR HIGH OUTPUT APPLICATIONS UTILIZING OIL OR GREASE LUBRICANT. THIS INJECTOR CAN BE STANDALONE OR IN A MANIFOLD CONFIGURATION WITH AN 3/8 NPTF INLET CONNECTION AND A 1/8 NPSF OUTLET. THE LSL-1A IS AVAILABLE IN ZINC PLATED CARBON STEEL, 303 STAINLESS STEEL, AND 316 STAINLESS STEEL.

SPECIFICATIONS

FOR: OIL AND GREASE

OUTPUT: STANDARD ADJUSTABLE OUTPUT FROM .01 CI TO .1 CI | HIGH OUTPUT FROM .015 CI TO .31 CI

PRESSURE: MAXIMUM/MINIMUM OPERATING PRESSURE 5000 PSI/1850 PSI

OUTPUT ADJUSTMENT

FACTORY OUTPUT IS SET AT, MAX OUTPUT. FOR MINIMUM OUTPUT, TURN THE HEX NUT CLOCKWISE INTO THE INJECTOR UNTIL IT BOTTOMS OUT (HAND TIGHT ONLY). FOR ACCURATE OUTPUT ADJUSTMENT, ROTATE THE HEX SCREW CLOCKWISE UNTIL IT BOTTOMS OUT, THEN ROTATE UNTIL THE DESIRED OUTPUT IS REACHED.

.01 CI TO .1 CI = 10 FULL TURNS

.015 CI TO .31 CI = **12.75 FULL TURNS**

1 FULL TURN = .01 CI (STANDARD OUTPUT) | .025 CI (HIGH OUTPUT)



DISASSEMBLY INSTRUCTIONS

STEP 1: First, remove the piston stop plug from the top of the injector body. Remove its contents (two washers & a gland), piston assembly, spring, and plunger assembly.

STEP 2: Next remove the adapter bolt from the manifold and injector body. Remove the injector internals, by first turning the injector upside down. Push out the Plunger assembly with a stick like object from the inlet side of the injector. It should fall out towards the adjustment adapter.

STEP 3: Remove the inlet disk, small and large glands, and inner washer from the injector body.

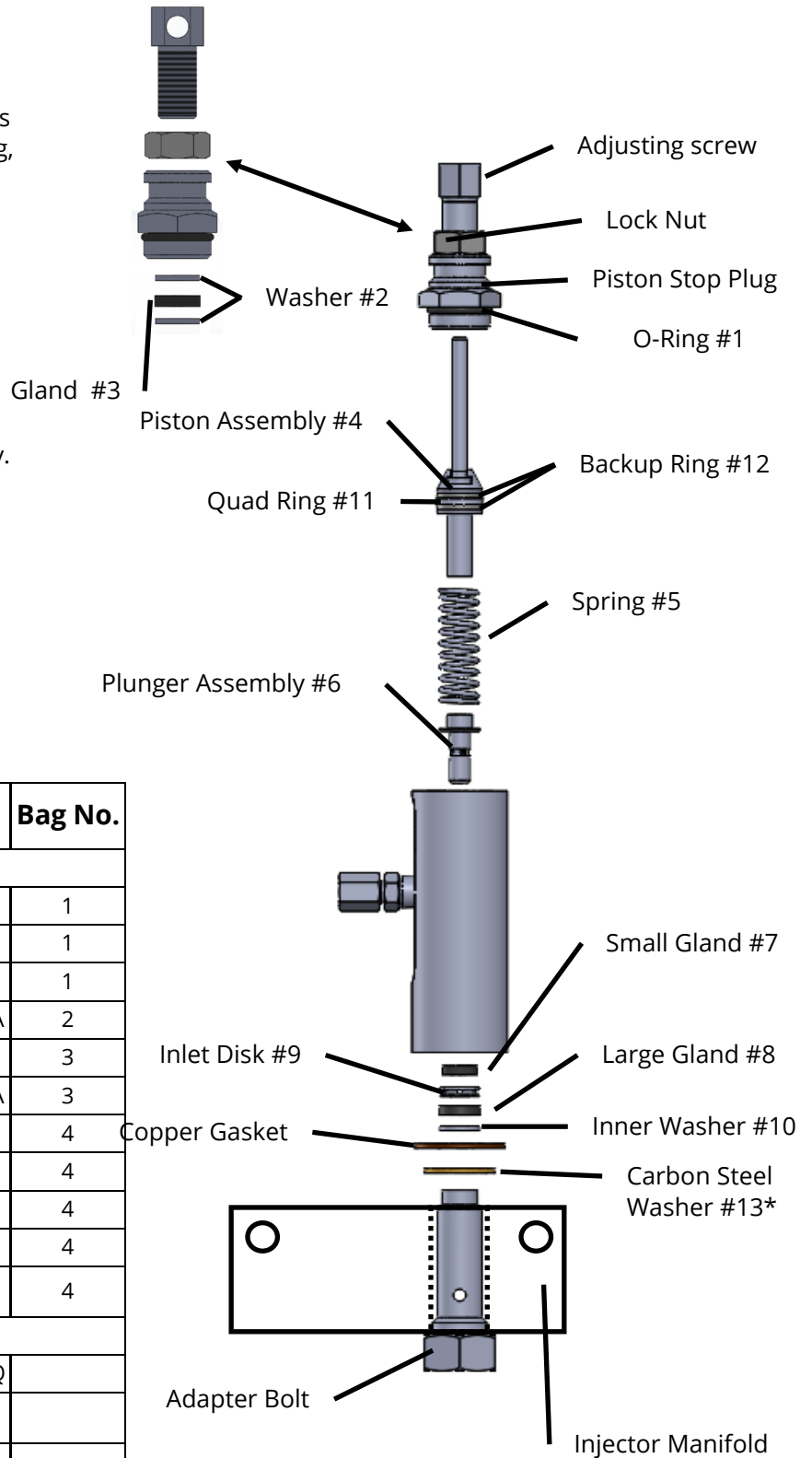

* Carbon Steel Gasket is installed above the adapter bolt and below the injector manifold

ORDERING SERVICE KITS	
LSL-1RK	SEAL KIT
LSL-1MRK	MAJOR REBUILD KIT

Item No.	Description	Qty.	Part No.	Bag No.
LSL-1MRK				
1	O-RING	1	12661-0022	1
2	WASHER	2	LSL85497-009	1
3	GLAND	1	LSL85497-006	1
4	PISTON ASSEMBLY	1	LSL81713-011A	2
5	SPRING	1	LSL81713-013	3
6	PLUNGER ASSEMBLY	1	LSL81713-004A	3
7	SMALL GLAND	1	LSL81713-010	4
8	LARGE GLAND	1	LSL81713-014	4
9	INLET DISK	1	LSL81713-009	4
10	INNER WASHER	1	LSL81713-007	4
13	CARBON STEEL WASHER	1	LSL81713-019	4
LSL-1RK				
11	QUAD RING	1	LSL81713-012Q	
12	BACKUP RING	2	LSL81713-012BR	
7	SMALL GLAND	1	LSL81713-010	
8	LARGE GLAND	1	LSL81713-014	
3	GLAND	1	LSL85497-006	
1	O-RING	1	12661-0022	

LSL-1A SERVICE INSTRUCTIONS

REASSEMBLY INSTRUCTIONS

STEP 1: Clean all injector components and inspect for wear. Replace parts and lube O-rings as necessary.

STEP 2: Install plunger assembly and spring into the injector body. Install backup rings and quad ring onto the piston assembly and guide the piston assembly into the spring as shown below.

STEP 3: Install O-Ring, gland, & the two washers as shown to piston stop plug and install to the injector body as shown. Install lock nut and adjustment screw.

STEP 4: Lube and insert small gland, inlet disk, large gland, and washer into the bottom of the injector body as shown.

STEP 5: Place the carbon steel gasket over the adapter bolt and insert into the manifold followed by the copper gasket and install into injector body as shown.

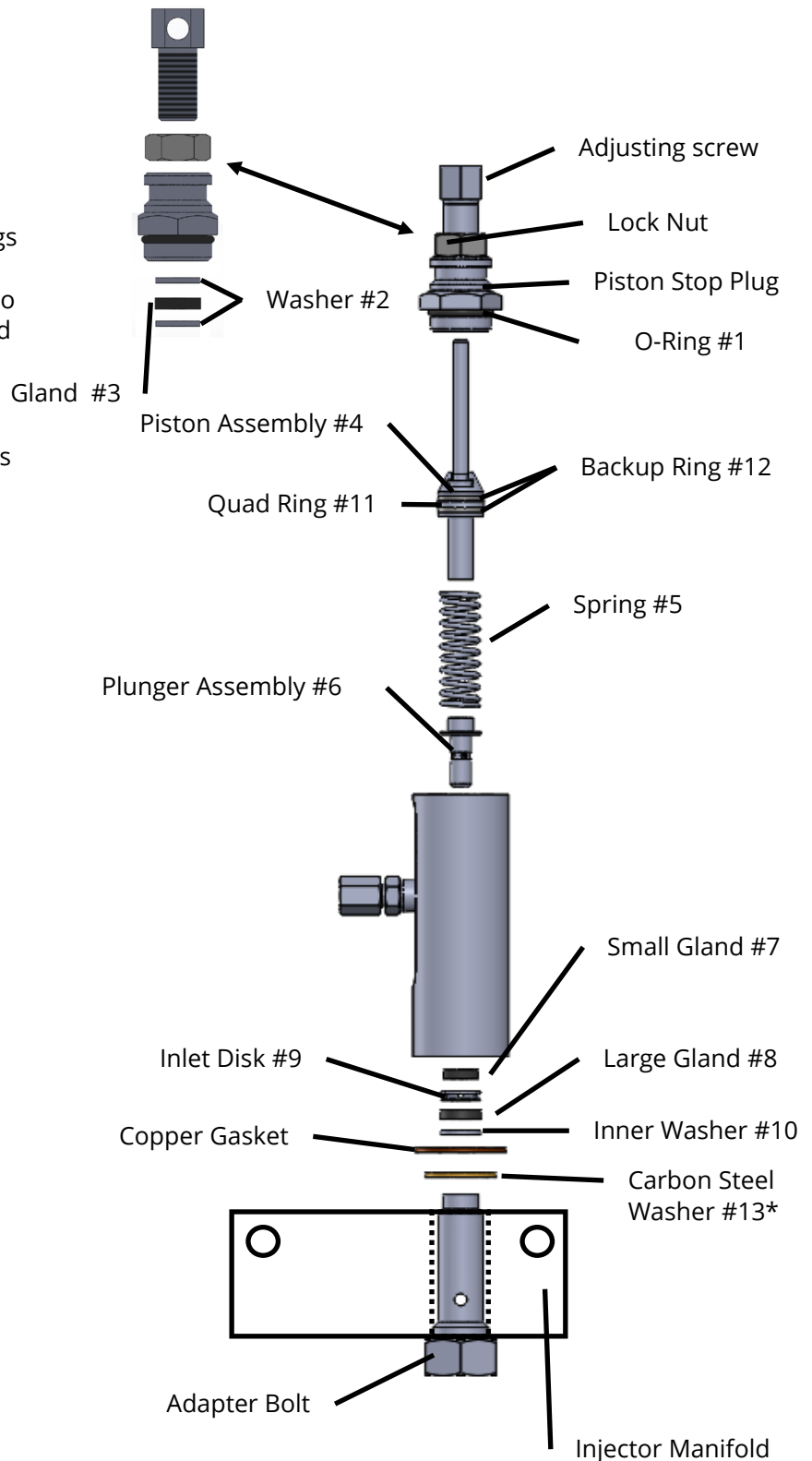

* Carbon Steel Gasket is installed above the adapter bolt and below the injector manifold

ADJUSTMENT INSTRUCTIONS

Loosen the lock nut

Turn the adjustment screw clockwise until it bottoms out. This will output 0.01 cubic inches of lubricant. One full turn will output an additional .01 cubic inches of lubricant maxing out at 0.1 cubic inches.

Standard Output Range = .01 CI—.1 CI

High Output Range = .015 CI—.31 CI

When desired output is achieved, secure the adjustment screw with the lock nut.

LSL-1A SERVICE INSTRUCTIONS

TROUBLESHOOTING GUIDE		
PROBLEM	AREA AFFECTED	REMEDY
POOR LUBRICANT FLOW TO BEARING	OUTPUT IS SET LOW	ADJUST TO PROPER SETTING AND LOCK WITH NUT (SEE
	WORN OR DAMAGED SLIDE VALVE BODY O-RINGS	REPLACE O-RING AND BACKUP RINGS (14, 15)
	PLUNGER SPRING BROKEN OR WORN	REPLACE SPRING (10)
TOO MUCH LUBRICANT FLOW TO BEARING	OUTPUT IS SET LOW	ADJUST TO PROPER SETTING AND LOCK WITH NUT (SEE
	WORN OR DAMAGED UPPER SLIDE VALVE BODY O-RING	REPLACE O-RINGS AND BACKUP RINGS (14,15)
	PLUNGER SPRING BROKEN	REPLACE SPRING (10)
	WORN OR DAMAGED SLIDE VALVE ASSEMBLY	REPLACE SLIDE VALVE ASSEMBLY
EXTERNAL LEAKAGE	DAMAGED O-RINGS	REPLACE O-RINGS (4)
LEAKAGE AT FITTING ASSEMBLY	LOOSE CAP	TIGHTEN CAP
EXTERNAL LEAKAGE AT	WORN OR DAMAGED INDICATOR PACKING	REPLACE PACKING (6)

Upgrade Assembly Instructions

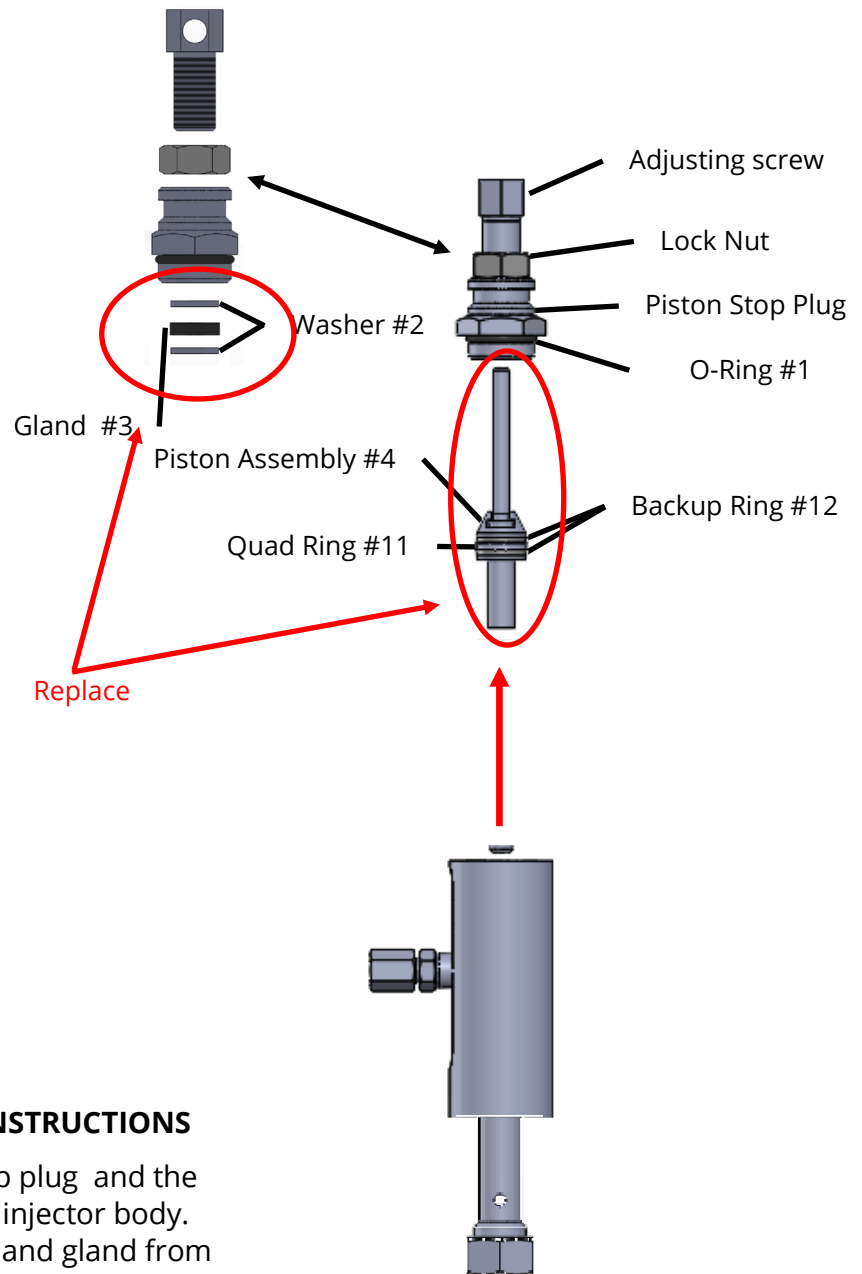

PISTON UPPER GLAND REBUILD INSTRUCTIONS

STEP 1: First, remove the piston stop plug and the complete piston assembly from the injector body.

STEP 2: Next remove the 2 washers and gland from inside the piston stop plug.

STEP 3: Replace piston assembly with new assembly kit provided.

STEP 4: Replace the two washers and gland into the piston stop plug assembly.

STEP 5: reassemble all contents into the injector body as shown.

NOTES

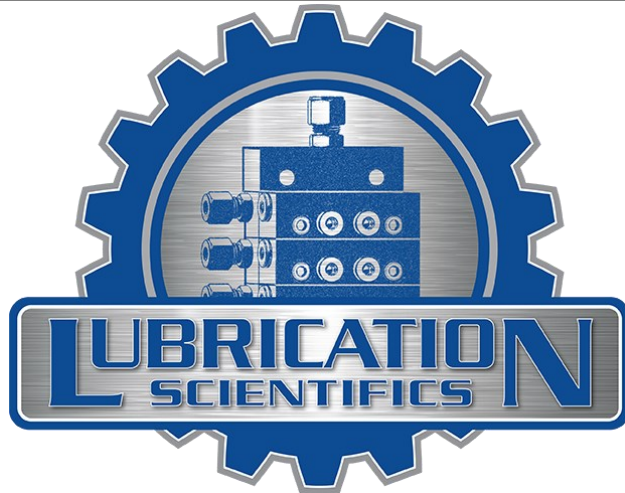

LUBRICATION SCIENTIFICS, LLC

17651 ARMSTRONG AVE.

IRVINE, CA 92614

UNITED STATES OF AMERICA

TEL: (714) 557-0664 FAX: (714)546-4564

WWW.LUBRICATIONSCIENTIFICS.COM